

CAPACITY

1250 people

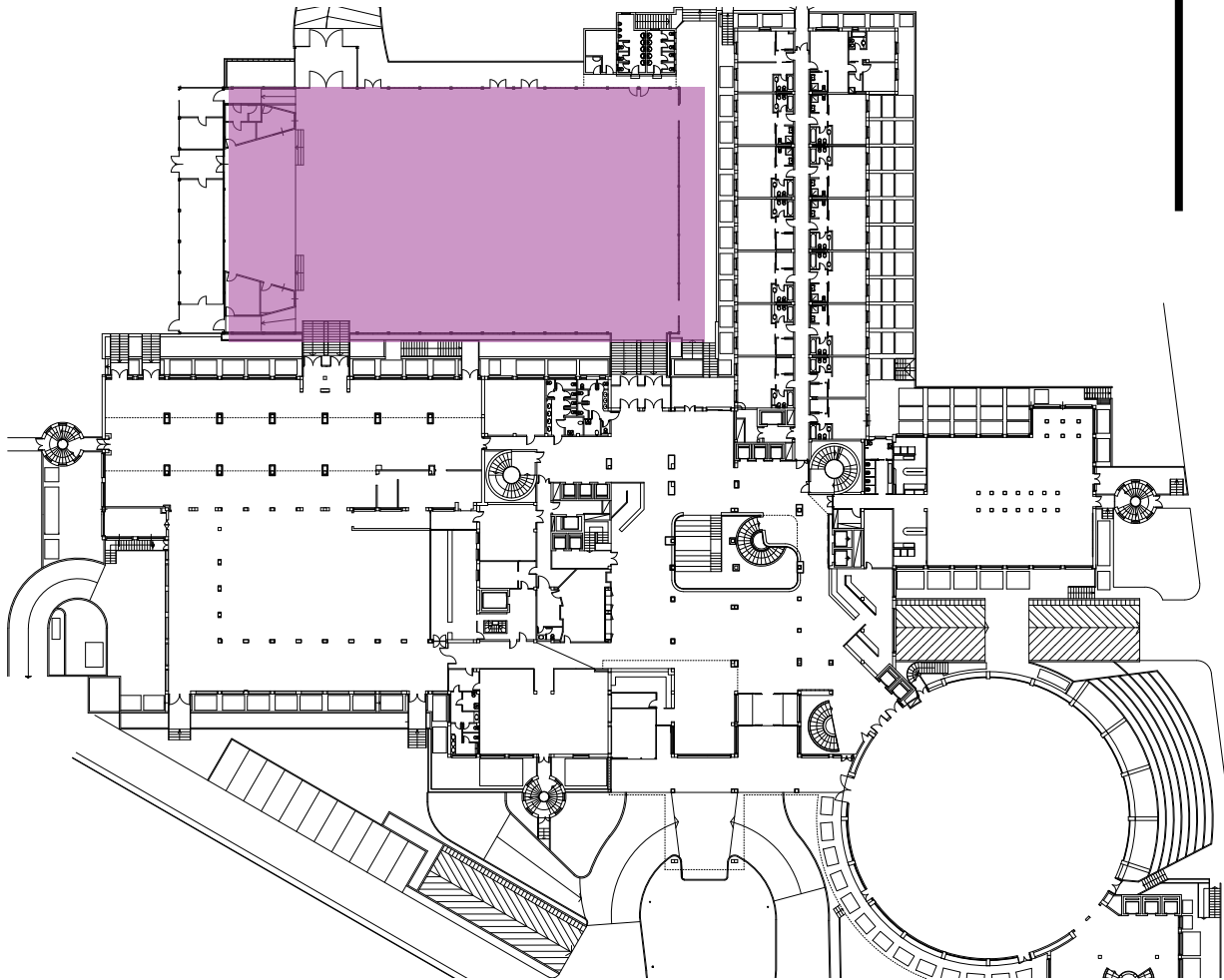

AVL TECHNOLOGY

- » 1x **Videowall 5.5 m wide × 3 m high**
- » **Stage x24 pieces**
system 2×1 m panels, adjustable height

- » Stage Power/Network

POWER

9×16 A outlets – 3×2.5 mm² cable

NETWORK

2×RJ45 network ports (show 1/2)

- » **5 available areas:** A, B, C, D, E
Each area is equipped with:
- » **1×three-phase 63 A** five-pole power feed
- » **8×network** cables for the video network

- » **The LED screen** will be mounted on a mobile frame with wheels for rapid movement between areas.

- » **Second option:** use of two separate mobile frames for greater flexibility

- » Near the screen: a **mobile flight case** for power and signal distribution

EXPO Control Room

- » Electrical panel
- » Rack with service equipment
- » Connected to the Main Control Room with 8 trunk network cables for:
- » Interconnection between areas
- » Remote control of video content
- » Streaming and other advanced functions